

# Handheld PID Monitors Quick Start Guide



**Honeywell**  
THE POWER OF CONNECTED

www.raesystems.com

BC

## User Interface

Functions are controlled via the [MODE] and [Y/+]  
keys. The display shows information such as  
monitored threats, real-time readings and measure-  
ment units, alarm type (when in alarm, including cal.  
overdue), battery status, datalog (if on), and radio and  
connection quality (if available).

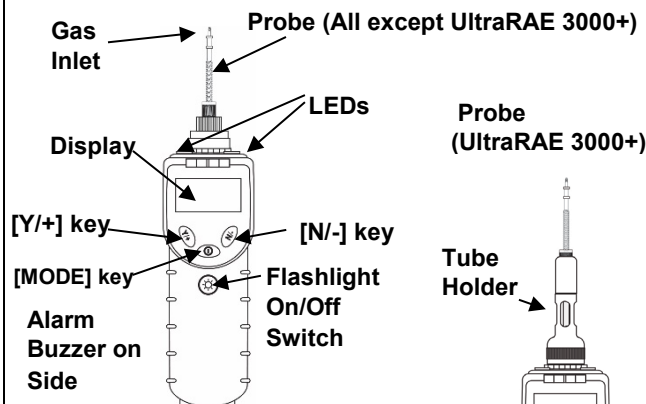

Charging and  
Communication Contacts on bottom

## Charging The Instrument

Always fully charge the battery before use. Contacts on  
the bottom of the instrument meet the Travel Charger's  
or Charging Cradle's contact pins, transferring power.  
Make sure the charger is firmly attached. Then connect  
the AC Adapter's plug to the charger, and plug its  
transformer into an AC outlet. While charging, the LED  
on the cradle glows red. When the battery is fully  
charged, the LED glows green. (Consult the User's  
Guide for more details on using the Charging Cradle.)

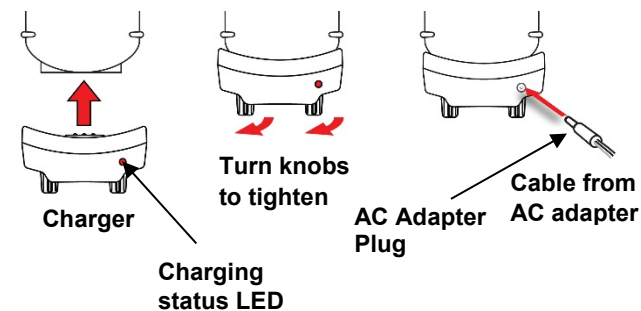

## Download The User's Guide

The free Handheld PID Monitors User's  
Guide is the complete manual for operating  
and maintaining all Handheld PID Monitors.  
It must be carefully read by all individuals who  
have or will have the responsibility of using,  
maintaining, or servicing the product.

Download the Handheld PID Monitors User's  
Guide here:

<https://www.raesystems.com/customer-care/resource-center/manuals>

Or, use your smart phone's camera:



## WARNINGS

### Read Before Operating

The User's Guide must be carefully read by all individ-  
uals who have or will have the responsibility of using,  
maintaining, or servicing this product. The product will  
perform as designed only if it is used, maintained, and  
serviced in accordance with the manufacturer's  
instructions.

**Note:** When the battery's charge falls below a preset  
voltage, the instrument beeps and flashes once every  
minute, and the "empty battery" icon blinks on and off  
once per second. You should turn off the instrument  
within 10 minutes and recharge the battery or replace it  
with a fresh one with a full charge.

### Turning The Instrument On/Off

With the instrument turned off, press and hold the  
[MODE] key until the audible alarm stops, and then  
release. During startup, it tests the battery, buzzer,  
vibration alarm, LEDs, and internal functions. Then the  
main reading screen is shown.

### Turning The Instrument Off

Press and hold [MODE] for the 5-second  
countdown to shutoff. When the countdown ends and  
the screen displays "Unit Off," release your finger from  
the [MODE] key. The instrument is now off.

## Hygiene & Search Modes

The instrument has two main operating modes:

**Hygiene Mode:** After warm-up, the instrument samples continuously.

**Search Mode:** After warm-up the pump shuts off and “Ready” is displayed. This is ideal for headspace sampling.

## Compound-Specific Measurement

The UltraRAE 3000+ can perform compound-specific measurement in addition to general VOC measurement. This requires using a RAE-Sep™ separation tube (butadiene or benzene) and having the UltraRAE 3000+ in Tube Mode, operating with a 9.8eV lamp.

The following are the 3 steps to make specific measurements:

1. Start the instrument and measure in TVOC.
2. If the reading is 0ppm, there is no need to enter specific measurement mode.
3. If the reading is higher than acceptable values, take an unopened RAE-Sep™ tube and break off both ends.
4. Insert the tube following the arrow.

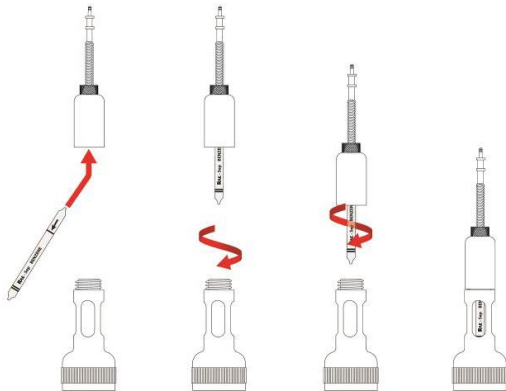

5. Trigger the specific measurement mode.

## Recommended Procedures

**Important!** Test the alarms prior to use. If any do not work, refer to the User's Guide for instructions. Do not use the instrument without functioning alarms.

**Check the pump:** Start the instrument and block the inlet to make sure the alarm is triggered and sounds and lights are functional. If the gas inlet is blocked but the pump does not shut down, or the pump shuts down too easily with a slight blockage, the pump threshold value may be set too high or low. Refer to the User's Guide for steps to correct this.

**Check whether the instrument responds to moisture:** Cup your hand over inlet for 10 to 20 seconds (do not block flow). If the instrument reads >2 ppm or if the ppbRAE 3000+ reads >500 ppb, then the sensor needs cleaning.

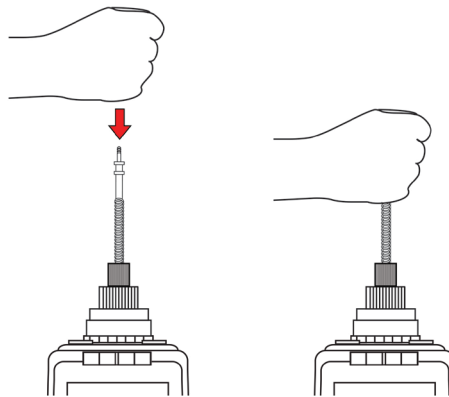

## Always Use An External Filter

Before using the instrument, attach an external filter to the sampling probe. This prevents moisture, debris, and other potentially clogging materials from entering the probe, preventing premature pump failure and keeping the sensor and lamp cleaner.

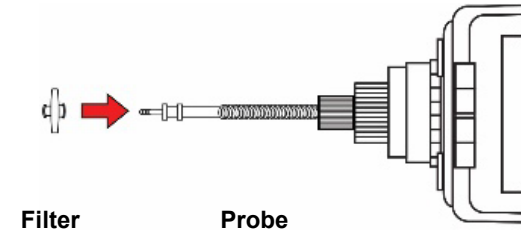

Filter

Probe

## Download The Device Configurator Mobile App



The Honeywell Device Configurator Mobile App provides the experience of managing safety (gas monitor) instruments on a mobile platform. It simplifies interaction with both portable and transportable gas monitors when they are in close proximity. It also provides the flexibility and convenience to access information stored on instruments without having to move them.

Download the free Device Configurator Mobility App

